

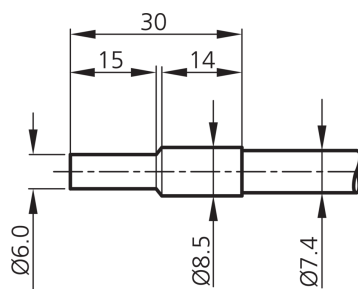

**201919**  
**WRB 110 S-8.5-4.0**  
**Glass fiber optics**

- High-quality glass fibers
- Resistant to high temperatures
- Robust, highly flexible



Technical data (typ.)	+20°C, 24 V DC
Length	300 mm
Dimension fiber bundle	Ø 4,0 mm
Light aperture	axial
Bending radius	> 3 x tube-Ø
Material	<ul style="list-style-type: none"> <li>■ Stainless steel (Sensor probe)</li> <li>■ Glass fibers (Fiber)</li> <li>■ Silicone-metal sleeve (Coating)</li> </ul>
Operating principle	Diffuse sensor
Design	Cylinder
Single fiber	Ø 0,05 mm
To be used for	Amplifiers for glass fiber optics
Opening angle	67°
Scanning range	150 mm
Temperature resistance	-40 ... +180 °C (temporarily up to +250 °C)
Protection type	IP 67
<b>More information / accessories</b>	<b><a href="https://www.di-soric.com/201919">https://www.di-soric.com/201919</a></b>